

A termini di legge ci riserviamo la proprietà di questo disegno con divieto di riproduzione e di renderlo comunque noto a terzi senza nostra autorizzazione
 This drawing is the property of and shall not be reproduced for any purpose without the consent of COMENDA s.r.l.

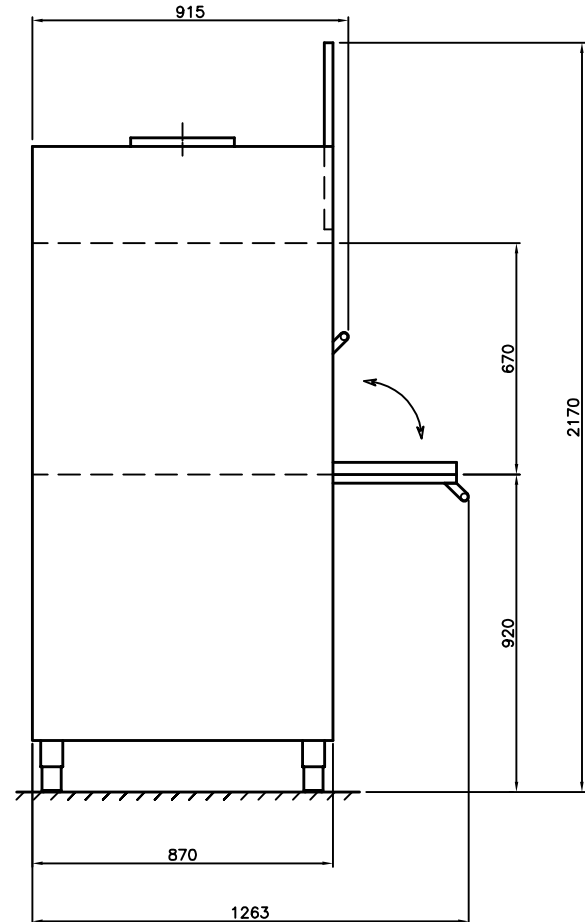

CESTELLO }
 RACK } 1320x700
 CESTA }
 PANIER }
 KORB }

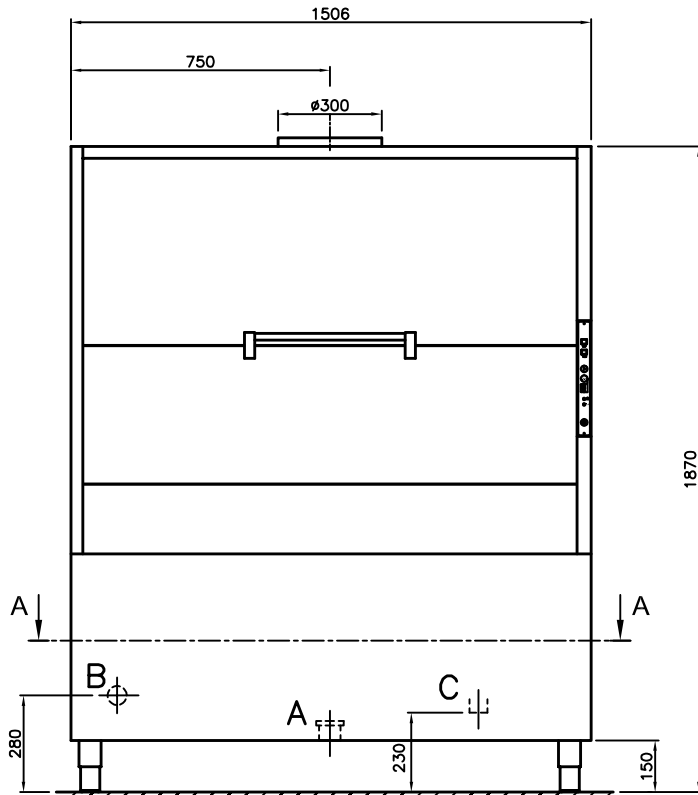
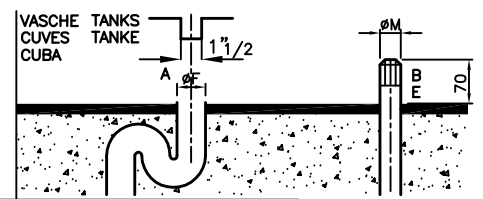
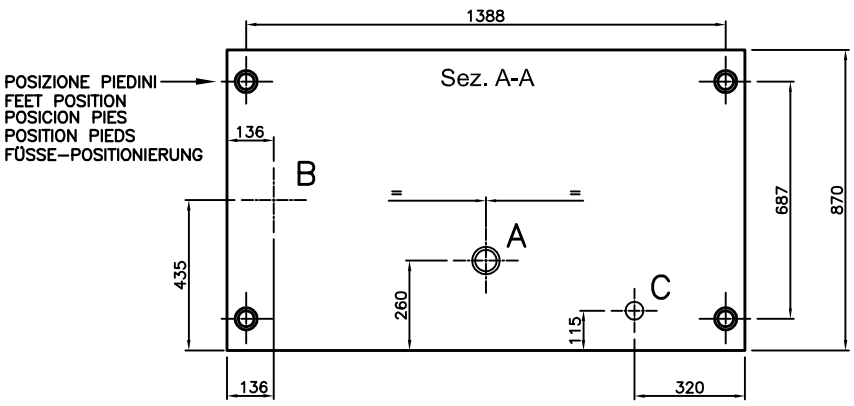

ALLACCIAMENTI - BRANCHEMENTS - CONNECTIONS - ANSCHLUSSE

A	SCARICO VASCHE - VIDANGE CUVES TANKS DRAIN - TANKEABLAUF	50mm min.	ØF	E*	ENTRATA VAPORE - ARRIVEE VAPEUR STEAM INLET - DAMPFZULAUF	} 0,5/2 BAR		ØM
B	ENTRATA ACQUA - ARRIVEE EAU WATER INLET - WASSERZULAUF	50/60°C -2/4BAR	3/4"	ØM	F*			3/4"
C	ALLACCIAMENTO ELETTRICO - BRANCHEMENT ELECTRIQUE ELECTRICAL CONNECTION - ELEKTROANSCHLUSS							

SCALE 1:15
 DATE 09/02/12
 SIGNATURE U.T.
 ARCHIVE REF.

MODEL: HD 130 BT
 MACHINE DIRECTION
 MODIFICATION

COMENDE S.r.l.
UNIPRODOTTORE ITALIANO (GRUPPO IRI)
IRI GROUP
 CODE N°
INH00010

A termini di legge ci riserviamo la proprietà di questo disegno con divieto di riproduzione e di renderlo comunque noto a terzi senza nostra autorizzazione
 This drawing is the property of and shall not be reproduced for any purpose without the consent of COMENDA S.r.l.

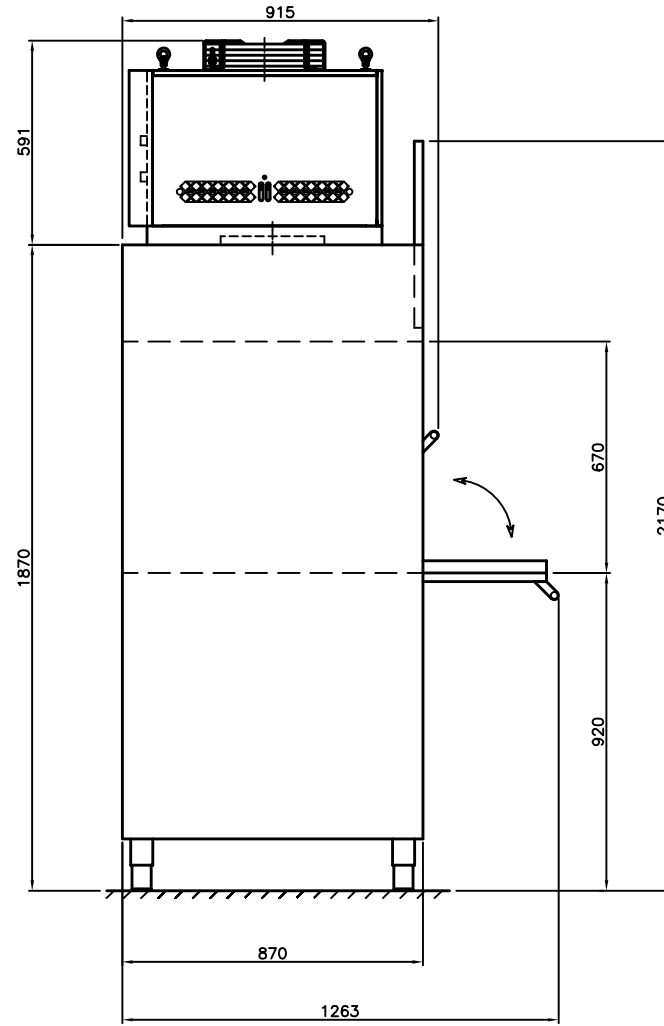
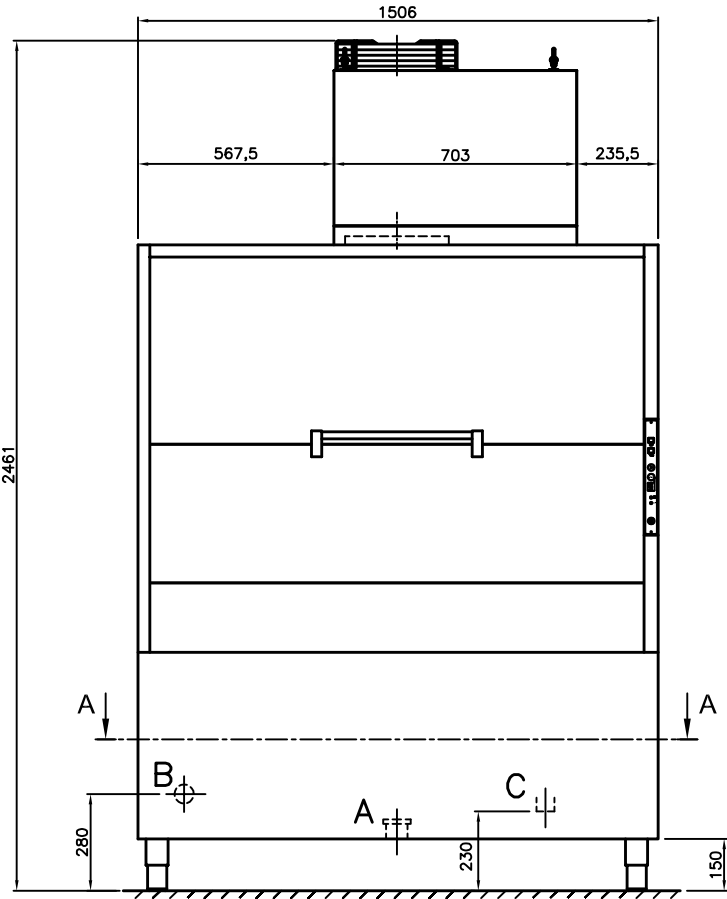

CESTELLO
 RACK
 CESTA
 PANIER
 KORB } 1320x700

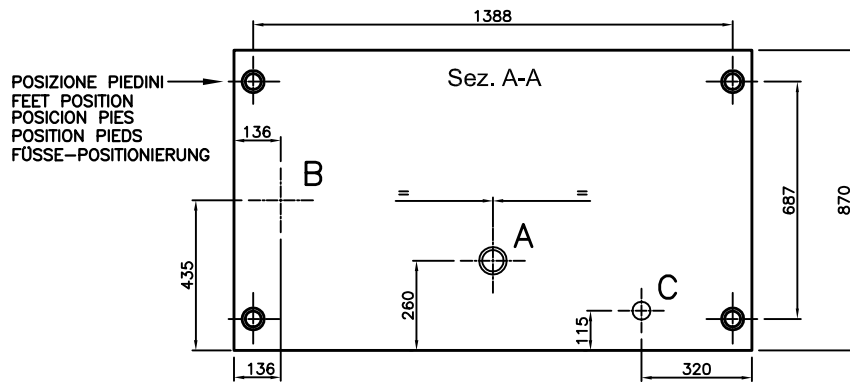

POSIZIONE PIEDINI
 FEET POSITION
 POSICION PIES
 POSITION PIEDS
 FÜSSE-POSITIONIERUNG

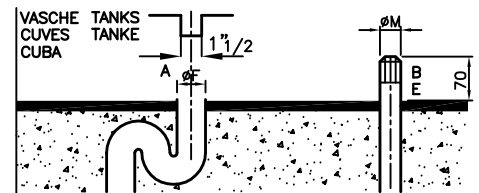

ALLACCIAMENTI - BRANCHEMENTS - CONNECTIONS - ANSCHLUSSE

A	SCARICO VASCHE - VIDANGE CUVES TANKS DRAIN - TANKEABLAUF	50mm min.	ØF	E*	ENTRATA VAPORE - ARRIVEE VAPEUR STEAM INLET - DAMPFZULAUF	} 0,5/2 BAR	ØM
B	ENTRATA ACQUA - ARRIVEE EAU WATER INLET - WASSERZULAUF	50/60°C -2/4BAR	3/4"	ØM	F*		SCARICO CONDENSA - SORTIE VAPEUR STEAM OUTLET - DAMPFABLAUF
C	ALLACCIAMENTO ELETTRICO - BRANCHEMENT ELECTRIQUE ELECTRICAL CONNECTION - ELEKTROANSCHLUSS						

SCALE
 1:15
 DATE
 25/07/12
 SIGNATURE
 U.T.
 ARCHIVE REF.

MODEL:
HD 130 BT - HP3
 MACHINE DIRECTION
 MODIFICATION



CODE N°
INH0027